

Fittings Mod. P7624 **Pro-Fit**[®]

Banjo Swivel

DIMENSIONS

Mod.	A	NPT D	E	G	H	L	N	W	SW
P7624 53-02	5/32	1/8	0.413	0.453	0.197	0.984	0.827	0.551	0.157
P7624 04-02	1/4	1/8	0.413	0.453	0.197	0.984	0.827	0.551	0.157
P7624 04-04	1/4	1/4	0.512	0.453	0.256	1.142	0.965	0.728	0.197
P7624 05-04	5/16	1/4	0.512	0.531	0.256	1.142	0.965	0.728	0.197
P7624 06-04	3/8	1/4	0.492	0.630	0.256	1.142	1.063	0.728	0.197
P7624 06-06	3/8	3/8	0.492	0.630	0.295	1.201	1.063	0.728	0.197



Fittings Mod. P7654 **Pro-Fit**[®]

Double Banjo Swivel

DIMENSIONS

Mod.	A	NPT D	E	F	G	H	L	M	N	W	SW
P7654 53-02	5/32	1/8	0.413	0.866	0.453	0.197	0.984	0.421	0.827	0.551	0.157
P7654 04-02	1/4	1/8	0.413	0.866	0.453	0.197	0.984	0.421	0.827	0.551	0.157
P7654 04-04	1/4	1/4	0.512	1.043	0.453	0.256	1.142	0.500	0.965	0.728	0.197
P7654 05-04	5/16	1/4	0.512	1.043	0.531	0.256	1.142	0.500	0.965	0.728	0.197
P7654 06-04	3/8	1/4	0.492	1.220	0.630	0.256	1.142	0.591	1.063	0.728	0.197
P7654 06-06	3/8	3/8	0.492	1.220	0.630	0.295	1.201	0.591	1.063	0.728	0.197

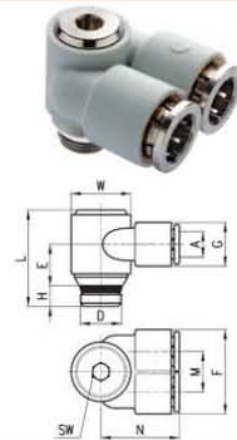

Fittings Mod. 7550

Union Elbow

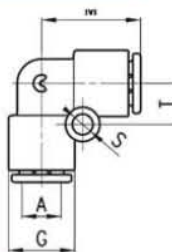

DIMENSIONS

Mod.	A	G	M	S	T
7550 53	5/32	0.354	0.669	0.157	0.256
7550 04	1/4	0.453	0.728	0.157	0.295
7550 05	5/16	0.531	0.807	0.157	0.335
7550 06	3/8	0.630	0.945	0.157	0.315
7550 08	1/2	0.768	1.102	0.157	0.378

Fittings Mod. 7540

Union Tee

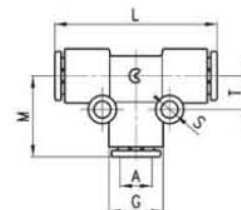

DIMENSIONS

Mod.	A	G	L	M	S	T
7540 53	5/32	0.354	1.339	0.669	0.157	0.256
7540 04	1/4	0.453	1.457	0.728	0.157	0.295
7540 05	5/16	0.531	1.614	0.807	0.157	0.335
7540 06	3/8	0.630	1.890	0.945	0.157	0.315
7540 08	1/2	0.768	2.205	1.102	0.157	0.378