



NPTF/INCH

3

FLOW CONTROL VALVES & ACCESSORIES

Ball Valves - Full Flow Design Series 2940, 2930 - NPTF/INCH

Ports 1/4", 3/8", 1/2", 3/4", 1", 1 1/4",
1 1/2", 2", 2 1/2", 3", 4", NPTF
Nickel-Plated (2040) and Plain Brass (2930)

Electroless nickel-plated: this plating offers excellent corrosion resistance, and is an FDA-approved material, making the Camozzi ball valve suitable for food packaging, chemical processing, medical, dental, water treatment, and printing markets, in addition to standard application.



TECHNICAL SPECIFICATIONS

Valve group	2/2, [way/positions]
Construction	Ball valve
Mounting	In-line
Materials	Brass body [2930], Nickel-Plated brass body [2940], Zinc-plated steel handles [2940] Plastic handles [2930], Hardened chrome-plated brass ball Teflon seat (P.T.F.E.)
Threaded port sizes	1/8", 1/4", 3/8", 1/2" NPTF [2930] 1/4", 3/8", 1/2", 3/4", 1", 1-1/4", 1-1/2", 2" NPTF [2940]
Installation	In-line
Operating temperature	Series 2940 5° - 300°F Series 2930 5° - 300°F
Fluid	Filtered air (for others, check with factory)

PNEUMATIC DATA

Working pressure	Series 2940: 1/4", 3/8", 1/2"	- 710 psi	2-1/2"	- 260 psi
	3/4", 1"	- 570 psi	3"	- 230 psi
	1-1/4", 1-1/2"	- 430 psi	4"	- 200 psi
	2"	- 360 psi		
	Series 2930: 1/4", 3/8", 1/2"	- 220 psi		
Nominal flow	Full flow design			

Ball Valve, Series 2940

These valves are constructed of an electroless nickel-plated brass body, a steel handle, a hardened chrome-plated brass ball, and a teflon seat. These valves are suitable for industrial, pneumatic, hydraulic, and various domestic installations. Among the various types of compounds which can be transported through these valves are steam, gasoline, fuel, oils, kerosene, acids, and compressed air.

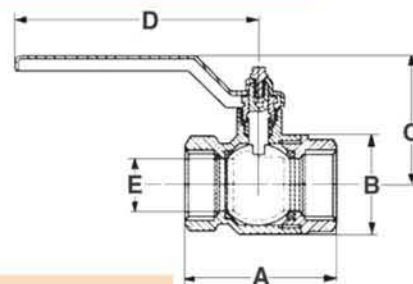

DIMENSIONS

Electroless Nickel-Plated Mod.	NPTF Thread	A		B		C		D		E		Working PSI
		mm	in	mm	in	mm	in	mm	in	mm	in	
2940-1/4PT	1/4"	44.4	1.748	23.5	0.925	37.0	1.457	80.0	3.150	10.0	0.394	710
2940 3/8PT	3/8"	44.4	1.748	24.0	0.945	37.0	1.457	80.0	3.150	10.0	0.394	710
2940 1/2PT	1/2"	50.5	1.988	30.5	1.201	41.0	1.614	80.0	3.150	15.0	0.591	710
2940 3/4PT	3/4"	57.5	2.264	37.0	1.457	55.0	2.165	113.0	4.449	20.0	0.787	570
2940 1PT	1"	70.0	2.756	45.5	1.791	59.0	2.323	113.0	4.449	25.0	0.984	570
2940 1 1/4PT	1-1/4"	80.5	3.169	57.0	2.244	74.5	2.933	137.5	5.413	32.0	1.260	430
2940 1 1/2PT	1-1/2"	94.0	3.701	70.0	2.756	80.5	3.169	137.5	5.413	40.0	1.575	430
2940 2PT	2"	112.5	4.429	84.0	3.307	96.5	3.799	157.0	6.181	50.0	1.968	360
2940 2 1/2PT	2-1/2"	128.0	5.039	96.0	3.780	109.0	4.291	197.0	7.756	54.0	2.126	260
2940 3PT	3"	148.0	5.827	119.0	4.685	126.0	4.961	250.0	9.842	65.0	2.559	230
2940 4PT	4"	169.0	6.654	138.0	5.433	135.0	5.315	250.0	9.842	80.0	3.150	200

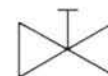

Min/Max working temperature: -20°C/+150°C (-4°F/+302°F)

Mini Ball Valve, Series 2930

These valves are constructed of all brass body, hardened chrome-plated brass ball, teflon seat, and light weight plastic handle.

Kv - Flow coefficient in M³/h → 100kPa differential pressure (ΔP 14.5 psi)

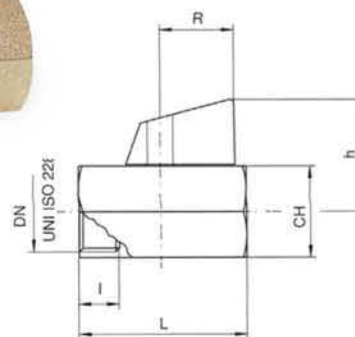

DIMENSIONS (in inches)

Economical Ball Valves								
Mod.	DN(NPTF)	CH	I	h	L	R	Kv(M ³ /h)	Kg
2930 1/8PT	1/8"	.857	.315	1.14	1.614	.807	4.3	0.11
2930 1/4PT	1/4"	.857	.394	1.14	1.614	.807	4.3	0.10
2930 3/8PT	3/8"	.857	.394	1.14	1.614	.807	2.7	0.09
2930 1/2PT	1/2"	.984	.433	1.22	1.811	.807	5.4	0.13

